



# RSA Reopening Plan March 2021 Welcome Back :)

School Site Specific Protection Plan  
(SSPP)  
Q&A Document

# Protective Measures Overview



- **All certificated staff** complete the Covid-19 Protocols - [PD Modules through Rise](#)
- **Cohorting** of students: MS: 3 per A/B, HS: 2 per A/B for 9th and 10th grade
- **Temp Screening** Check-point daily of students (MPR for MS, Yard Gate for HS)
- **Mask Policy** (minimum requirements: staff: 3-ply, **students:** cloth or other)
- Student/Teacher **Shields:** Desktop at all times, teacher stations as often as able
- **Surface** Decontaminating: HS Classrooms between periods(students), lunch area
- **Physical Distancing:** Maintain 6ft ring outside and inside buildings
- **Handwashing** and **Sanitizer:** All sinks(soap) and Sani: lunch areas, outside offices
- **Directional** Markers and Signage: for traffic flow and distancing
- **Campus Flow:** HS, counterclockwise, MS wings one way flow in and out of rooms
- **Symptomatic** Students: Isolation Area-w/ Health Sub (MPR)
- Staggered **release** of students at end of instruction daily

# General Daily Schedule(s) at a Glance



## Middle School

## High School

7:30-7:45	Teacher Arrival		
7:45-8:05	DL Group Block 1		DL Group Block 1
8:05-8:10	Passing Period		Passing Period
8:10-8:30	DL Group Block 2		DL Group Block 2
8:30-8:35	Passing Period		Passing Period
8:35-8:55	DL Group Block 3		DL Group Block 3
8:55 - 9:10	Teacher Break		Independent - 195 Min
9:10-9:40	Welcome Students to Classroom	Student Arrival to School	
9:40-10:50	Block 1 - 70 Min	Block 1 - 70 Min	
10:50-11:00	Passing Period	Passing Period	
11:00-12:10	Block 2 - 70 Min	Block 2 - 70 Min	
12:10-12:45	Lunch	Lunch	Suggested Lunch
12:45-12:55	Passing Period	Passing Period	Independent - 95 Min 12:55 - 2:30
12:55-2:05	Block 3 - 70 Min	Block 3 - 70 Min	
2:05-2:25	Dismissal 2:20 Teacher Prep	Dismissal	
2:40-3:30		**Independent - 50 Min	

\*\*2:05-2:40 - Dismissal and student transition

7:30-7:45	Teacher Arrival			
7:45-8:05	DL Group Block 1	Independent* - 60 Min 7:45-8:45	DL Group Block 1	
8:05-8:10	Passing Period		Passing Period	
8:10-8:30	DL Group Block 2		DL Group Block 2	
8:30-8:35	Passing Period		Passing Period	
8:35-8:55	DL Group Block 3		DL Group Block 3	
8:55-9:05	Teacher Break	Student Arrival to School	Independent* - 200 Min	
9:05-9:25	Welcome Students to Classroom			
9:25-10:45	Block 1 - 80Min			Block 1 - 80 Min
10:45-10:55	Passing Period			Passing Period
10:55-12:15	Block 2 - 80Min			Block 2 - 80 Min
12:15-12:50	Lunch	Lunch	Suggested Lunch	
12:50-1:00	Passing Period	Passing Period	Independent* - 100 Min 12:50 - 2:30	
1:00-2:20	Block 3 - 80 Min	Block 3 - 80 Min		
2:20-2:40	Dismissal 2:20 Teacher Prep	Dismissal		
2:40-3:30		Independent* - 50 Min	*100 min per period + DL time	

\*Independent time for In-Person group = 37 min per block



# RSA Daily Schedule(s) at a Glance

Grade 5-7		Grade 8		Grade 9-12	
Welcome	9:10-9:40	Welcome	9:10-9:40	Welcome	9:05-9:25
Period 1/2	9:40-10:50	Period 1/2	9:40-10:50	Period 1/2	9:25-10:45
Lunch	10:50-11:25	Passing/Break	10:50-11:00	Passing/Break	10:45-10:55
Passing/Break	11:25-11:35	Period 3/4	11:00-12:10	Period 3/4	10:55-12:15
Period 3/4	11:35-12:45	Lunch	12:10-12:45	Lunch	12:15-12:50
Passing/Break	12:45-12:55	Passing/Break	12:45-12:55	Passing/Break	12:50-1:00
Period 5/6	12:55-2:05	Period 5/6	12:55-2:05	Period 5/6	1:00-2:20
Dismissal	2:05-2:40	Dismissal	2:05-2:40	Dismissal	2:20-2:40



# Student Arrival

1. Check-In: **HS Station Opens at 9:05am, MS Station at 9:10am** - Teaching staff to be ready at those times to receive students - doors open
2. Students exit check-in, then report directly to 1st/2nd Period Classroom Assignment
3. MS: Students take assigned seat (Grade 5-8) - use name stickers on desks  
HS: Students wipe down desk, but create seating chart
4. Instruction Begins: **HS 9:25am , MS 9:40am**
5. Tardies: No marking “tardy” students - just as with distance instruction

# Student Arrival

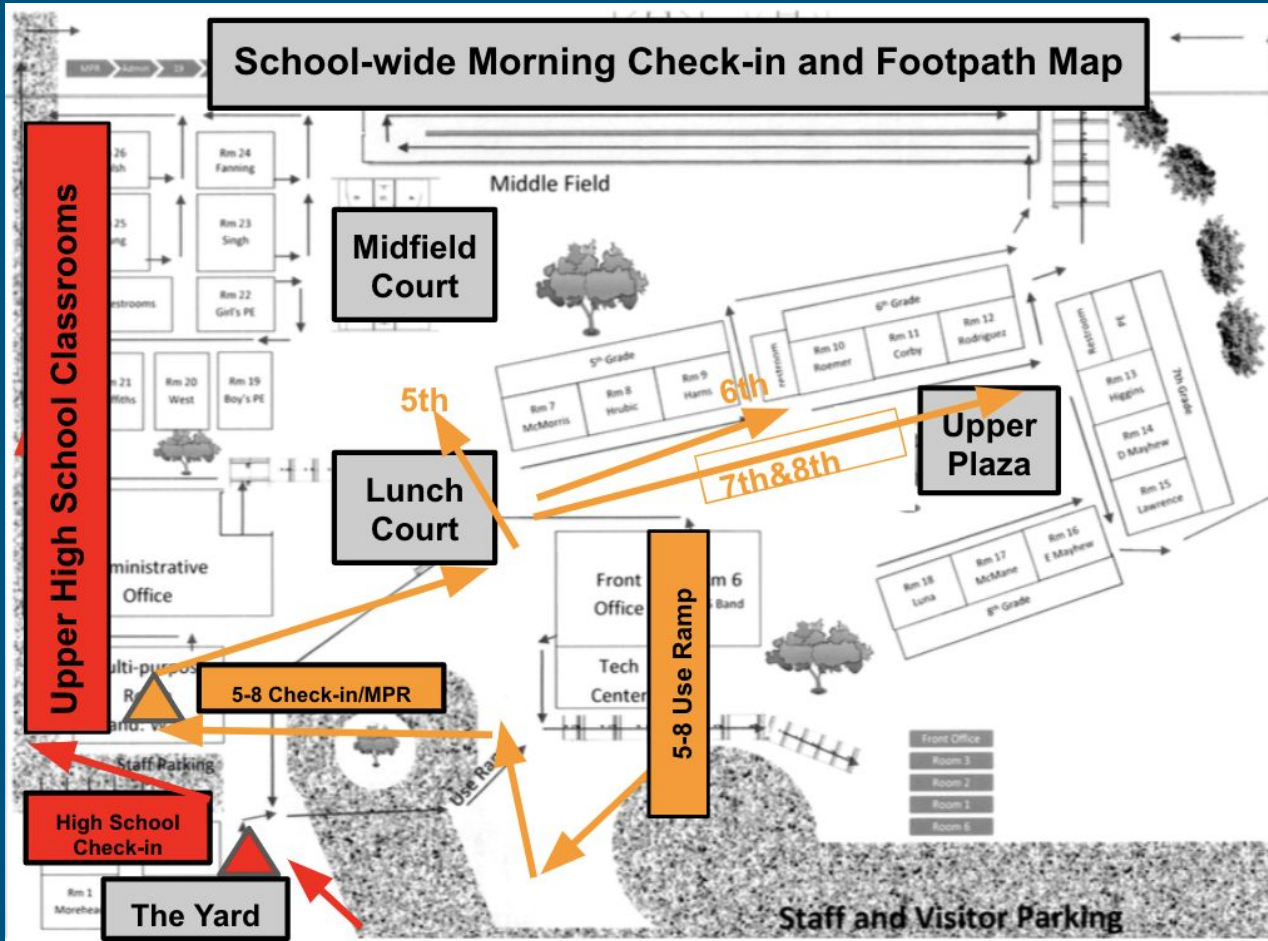



# In and Around the Classroom

- Limit **student movement** to individuals (restroom, sink, trash, dismissal system)
- **Collaboration** digitally, whole group, but no regrouping of chairs/desks
- **Restroom** as needed, no pass, one at a time, do not wait for class breaks
- **Mask Compliance** - gentle reminders - if becoming defiance - summon campus supervisor
- Ill or **symptomatic student**? Call Health Office before sending to isolation area
- **Sharing** Materials? Avoid, must clean between any changing of hands within or between cohorts
- **Tech** Issues: Have back-up plan/manipulatives (paper ok)
- **HS Passing** (Student Pre and Post wipe down protocol)
- **MS Passing** Teacher rotations, students remain, stretch in place, class walks
- **HS Open Period Students**: Assigned to space within classrooms, within cohort
- **MS PE Release**: Drop-off and Pick-up at stairway, one class at a time, use system for order of release. See [PE Release Map](#)

# Lunch

Cohort Lunch Area Assignments				
	Lunch Court	Midfield Court	Upper Plaza	The Yard
Lunch 1 10:50-11:25	5th Grade (55 Students)	6th Grade (55 Students)	7th Grade (55 Students)	
Lunch 2 12:10-12:45 (8th) 12:15-12:50 (HS)		9th and 10th (55 students)	8th Grade (55 Students)	11th and 12th (45 Students)



See [Lunch Maps](#) Grab and Go only.

- MS Release - in room order system following flow of map. Return in reverse order - teacher pick-up/signal - Teams work out return system
- HS Release - 9/10 to Midfield, 11/12 to Yard following flow - Return bell signal to release back to class, open doors monitor milling (should be none)
- Seating in lunch areas by cohort, bench stickers for separation
- Inclement weather - classrooms, brown bag delivery for school lunch, supervision by classified staff, teacher voluntary



# Dismissal - Middle School



Begins at 2:05 - No Mass Dismissal

**2:00** - Release Bus Riders to Horseshoe to Meet Campus Supervisor

**2:05** - Begin "Waiting Room" Manual Dismissal System \*:

- Open Dismissal Spreadsheet - display for students
- List will populate with numbers (all students assigned a number 1-105)
- Students exit individually when number appears

**2:30** - Release remaining students to lower lot waiting area



# Dismissal - High School

Begins at **2:20** - Staggered room dismissal - in room system desk to desk - Upper rooms may use North Exit

**2:20** - Room 1 and 26

**2:23** - Room 2 and 25

**2:26** - Room 3 and 24

**2:29** - Room 21 and 23

**2:32** - Room 20 and PE

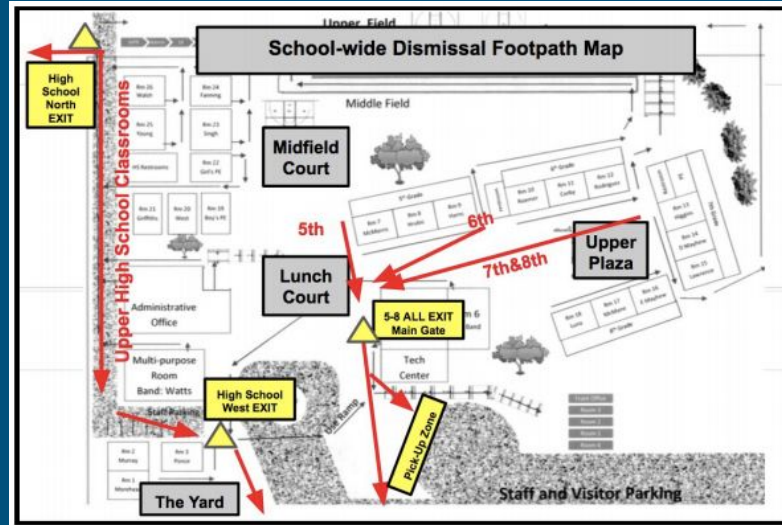

HS Students greet rides in front of school or walk off campus to parked cars- (lower lot only for MS. unless student drivers are accessing their personal vehicles)

# Keeping in mind, the big picture

---

- Period of reacclimation for all of us
- Grace, empathy, patience
- Prioritization of rebuilding connections with kids on campus

# Questions

---

[Q & A Document Link](#)